

### BALL CHECK VALVE FLANGED END

#### APPLICATION:

Waste water, sewage, sticky fluids, raising water

#### GENERAL CHARACTERISTICS:

Range from ND50 up to ND600.

The rubber ball is totally encapsulated for superior sealing and corrosion resistance.

Installation in horizontal or vertical position.

Low head loss. Low noise.

100% sealing at 0.3bar

Epoxy paint 250 microns RAL 5015.

#### STANDARDS:

Design: BS5153, EN 1074-3.

Face to Face: EN 558-1 Series 48.

Mounting between flanges: PN10/16 EN 1092-2, ISO 7005-2.

Pressure Test: EN 12266-1 Rate A.

Body: 24 bar. Seat: 11 bar.

EU directive 2014/68/EU Equipment's under pressure: Cat. III mod. H.

#### WORKING CONDITIONS:

Maximum Working Pressure: 16 bar.

Working Temperature: - 5 °C / + 90 °C.

Suitable Media: Water

Consult Factory for other applications



ITEM	PART	MATERIAL
1	Body	GJS500
2	Ball	Steel + NBR
3	Gasket	NBR
4	Bonnet	GJS500
5	Purge Plug	A2
6	Bolts	A2

ND	L	H	Weight KG
050(4")	200	98	8,7
065(5")	240	115	11,3
080(6")	260	137	15,4
100(4")	300	154	18,8
125(5")	350	180	27,7
150(6")	400	220	40,1
200(8")	500	287	61,1
250(10")	600	355	101
300(12")	700	425	145
400(16")	900	584	305

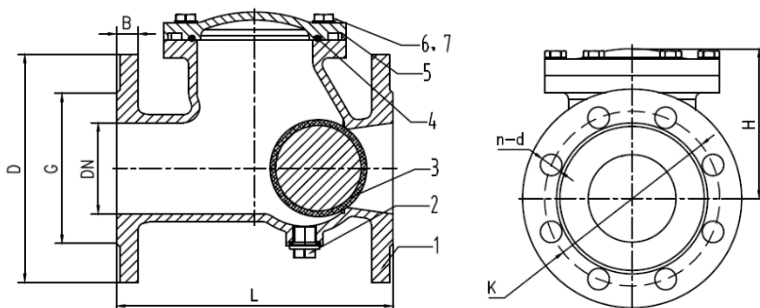

## BALL CHECK VALVE FLANGED END

Horizontal or Vertical Installation

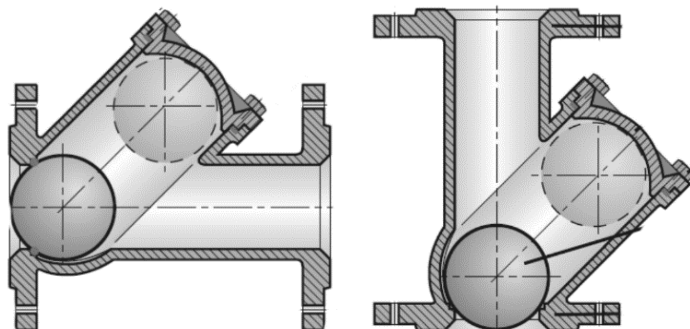

### CURVAS PERDIDA DE CARGA / PRESSURE DROP CURVE

#### TIPO BRIDAS / FLANGED

