

UNIDIRECTIONAL SEALING KNIFE VALVE



MODEL: 800A

WORKING PRESSURE:

DN50-DN100 16Bar DN125-DN200 14Bar
 DN250-DN300 12Bar DN350-DN400 10Bar
 DN450-DN550 8Bar DN600-DN650 5Bar
 DN700-DN750 4Bar DN800-DN900 3Bar
 DN1000-DN1400 2Bar

STANDARDS:

Design: MSS SP-81
 Flange Standard: DIN PN10, PN16, 150LB, JIS 10K, TABLE E/D
 Face to Face: MSS SP-81
 Testing Standard: API-598
 Transmission: manual, electric, pneumatic, hydraulic, electro-hydraulic, gear

GENERAL CHARACTERISTICS:

Main Material: WCB, CF3M, CF8
 Wedge Material: SS316L, SS304
 Sealing Material: NBR, EPDM, FKM, Metal
 Packing Aramid fiber, high-water-based rubber packing graphite wheel for Applicable
 Medium: pulp, cement slurry, gold or powder, coal slurry pulp, chemical treatment of sewage, sedimentation tanks, asphalt, acid and other liquids and other media.

FEATURES:

- Unidirectional sealing
- 1PC Body design
- Full port design
- Mixed with a variety of materials packing

PRODUCT DESCRIPTION:

800A Series Knife gate valve is with replaceable rubber seal knife gate structure, its sealing principle is mainly by closely connection between gate and rubber seals. Its main characters are that the rubber sealing ring is set in seat' groove and is locked by metal seat, which will prevent rubber seal off when opening and closing the valve. If the seal is broken, you can remove the metal sear and replace the rubber seal, which will greatly improve valve' working efficiency. This valve is a cost-effective, high-performance products. The series of knife gate valve can be equipped with pneumatic actuators, to meet the requirements of different industrial and mining use.

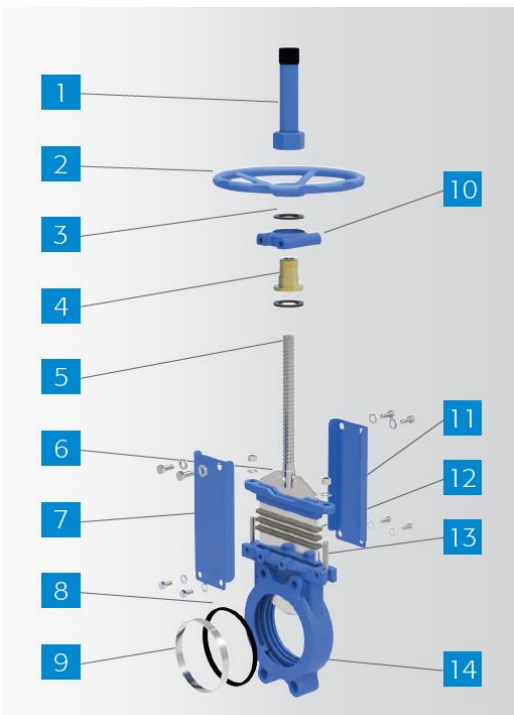

No.	Part	Material	QTY
1	Handle Cover	Q235+Painting	1
2	Hand Wheel	GGG40	1
3	Bearing	Zchsnsb 10-6	2
4	Stem Nut	Brass	1
5	Stem	2Cr13/SS304/SS316	1
6	Disc	SS304/SS316/F55/2205	1
7	Yoke	Q235	1
8	Seat	EPDM/NBR/PTFE/Metal	1
9	Seat Cover	SS304/SS316	1
10	Yoke Head	GGG40	1
11	Packing Gland	WCB/CF8	1
12	Packing	Aramid PTFE	3-5
13	Bolt	Fe+Zn with Painting/SS304	N
14	Body	WCB/GGG40/CF8/CF8M	1



UNIDIRECTIONAL SEALING KNIFE VALVE

Dimension

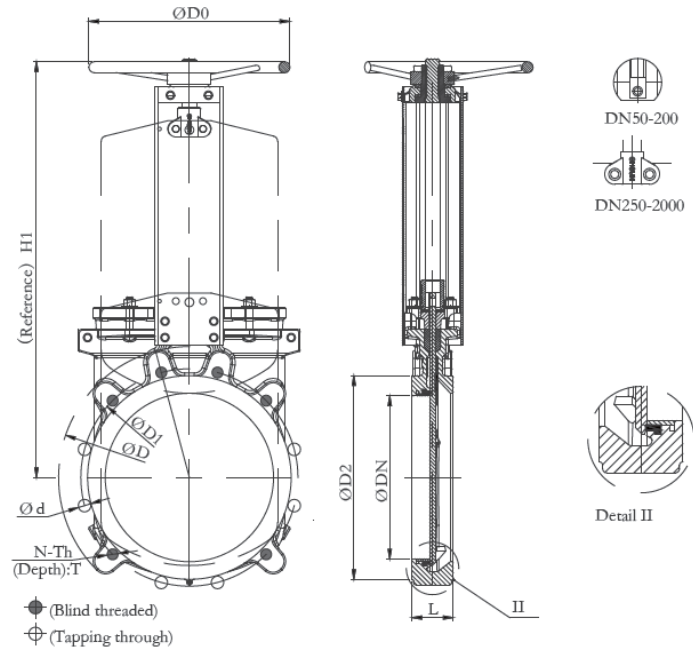

ANSI 150LB

DN	L	D	D1	D2	D0	N-Th	d (φ)	H1
2"	48	152	121	92	180	4-5/8"	19	260
2-1/2"	48	178	140	105	200	4-5/8"	19	292
3"	51	191	153	127	200	4-5/8"	19	320
4"	51	229	191	157	240	8-5/8"	19	358
5"	57	254	216	186	260	8-3/4"	22	395
6"	57	279	242	216	280	8-3/4"	22	450
8"	70	343	299	270	300	8-3/4"	22	532
10"	70	406	362	324	320	12-7/8"	25	670
12"	76	483	432	381	350	12-7/8"	25	758
14"	76	533	476	413	400	12-1"	29	857
16"	89	597	540	470	450	16-1"	29	946

DIN2632 PN10

DN	L	D	D1	D2	D0	N-Th	d(φ)	H1
50	48	165	125	99	180	4-M16	18	260
65	48	185	145	118	200	4-M16	18	292
80	51	200	160	132	200	8-M16	18	320
100	51	220	180	156	240	8-M16	18	358
125	57	250	210	184	260	8-M16	18	395
150	57	285	240	211	280	8-M20	23	450
175	57	305	265	237	280	12-M20	23	504
200	70	340	295	266	300	8-M20	23	532
250	70	395	350	319	320	12-M20	23	670
300	76	445	400	370	350	12-M20	23	758
350	76	505	460	429	400	16-M20	23	857
400	89	565	515	480	450	16-M24	27	946



UNIDIRECTIONAL SEALING KNIFE VALVE

PN10 Threaded hole and Tapping hole

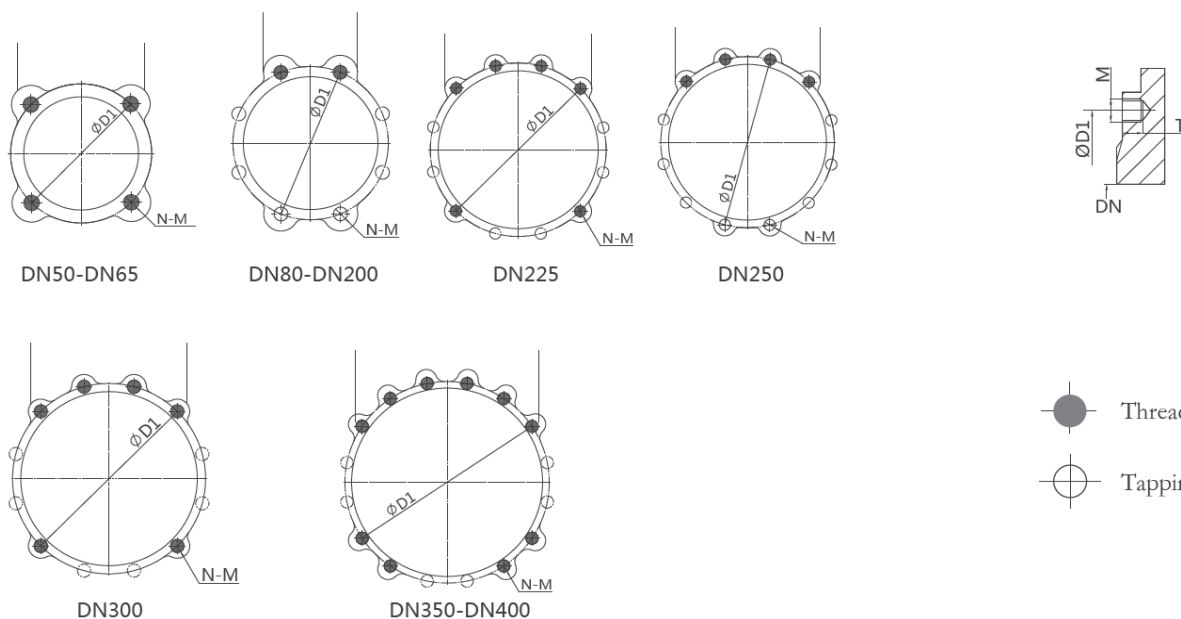

PN10						
DN	D1	N	M	T	Thread Hole	Tapping Hole
50	125	4	16	13	2	2
65	145	4	16	13	2	2
80	160	8	16	13	2	6
100	180	8	16	13	2	6
125	210	8	16	16	2	6
150	240	8	16	16	2	6
200	295	8	16	20	2	6
225	310	12	20	20	6	6
250	350	12	20	20	4	8
300	400	12	20	20	6	6
350	460	16	20	20	10	6
400	515	16	24	24	10	6



UNIDIRECTIONAL SEALING KNIFE VALVE

ANSI 150LB						
DN	D1	N	M	T	Thread Hole	Tapping Hole
2"	121	4	M5/8-11	13	2	2
2-1/2"	140	4	M5/8-11	13	2	2
3"	153	4	M5/8-11	13	2	2
4"	191	8	M5/8-11	13	2	6
5"	216	8	M3/4-10	16	2	6
6"	242	8	M3/4-10	16	2	6
8"	299	8	M3/4-10	20	2	6
10"	362	12	M7/8-9	20	2	6
12"	432	12	M7/8-9	20	6	6
14"	476	12	M1-8	20	6	6



150LB Threaded hole and Tapping hole

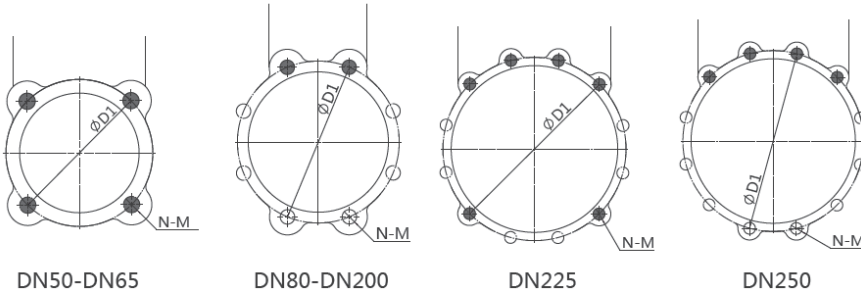

DN50-DN65

DN80-DN200

DN225

DN250

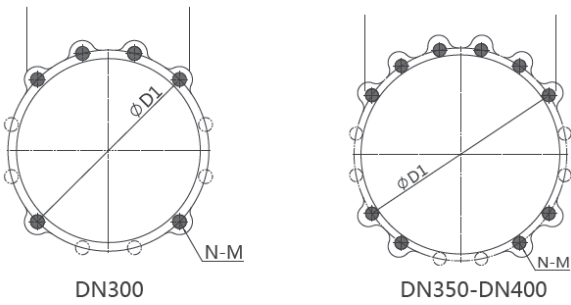
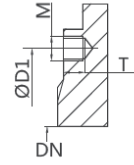

DN300

DN350-DN400

